

1. IZLOULEN - GENERAL CONTEXT & MACRO TRANSPORTATION

Douar Izloulou, located in the High Atlas Mountains, is 110 km from Marrakech and 210 km from Beni Mellal via the Ait Hkim and Ait Yzid roads on the RN09. It is situated at the intersection of the Marrakesh-Safi, Beni Mellal-Khénifra, and Drâa-Tafilalet regions.

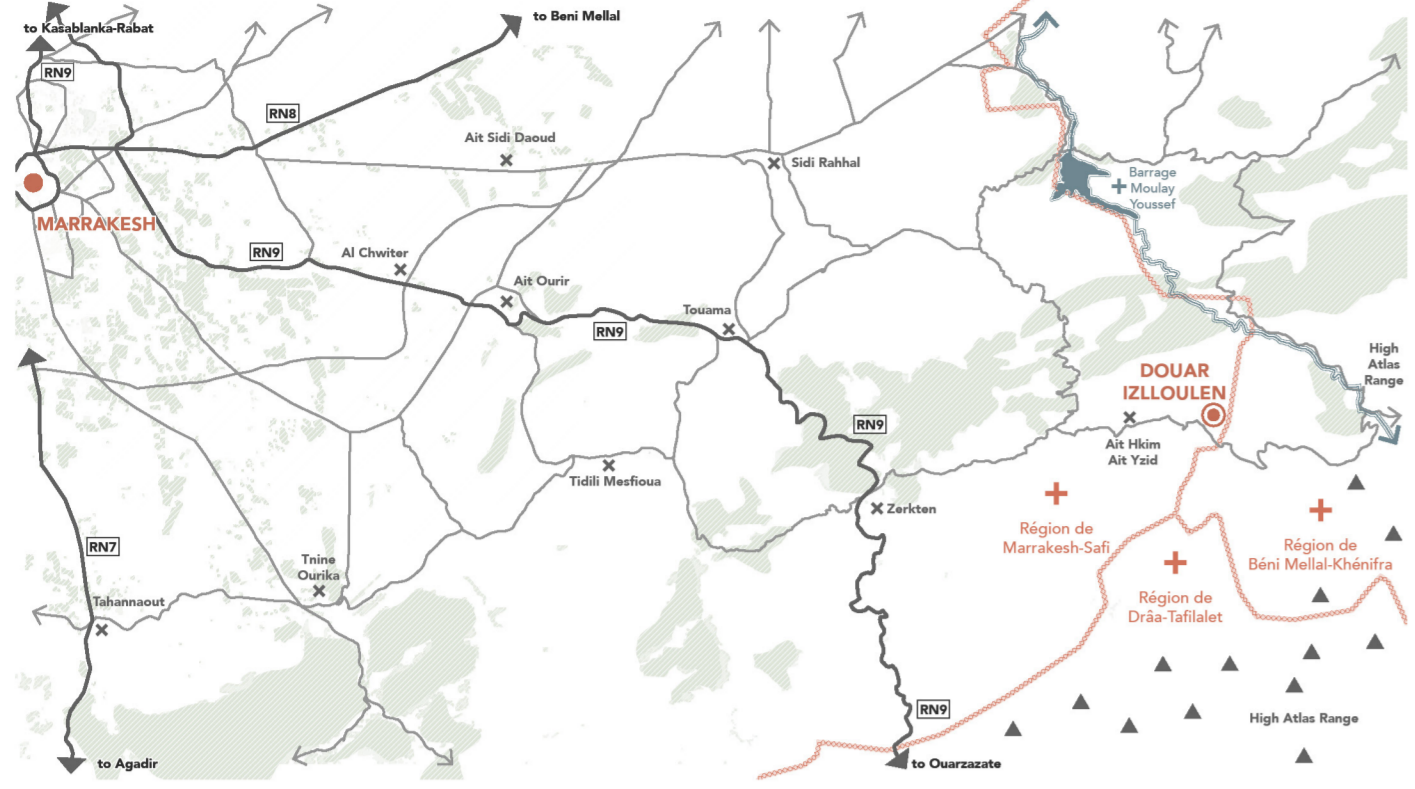

2. IZLOULEN - CONNECTIONS WITH SURROUNDING DOUARS

Izloulou is surrounded by the douars of Aguenswan, Askenfou, Igdamen, and Issoual. The road leading to Ait Ouallane, where agricultural terraces are located in the northwest, is in better condition compared to other roads. The presence of many settlements along this axis creates a basis for social interaction between the douars.

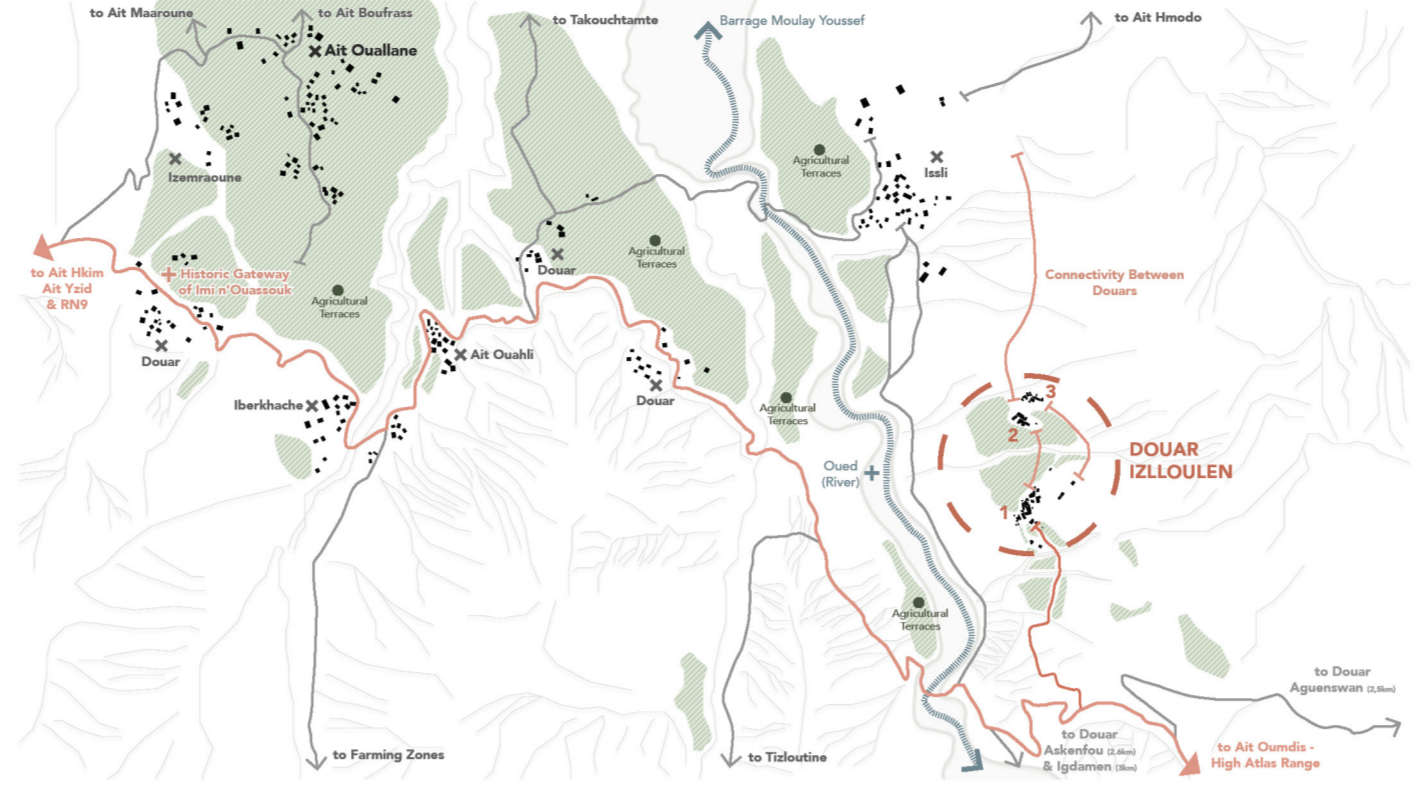

3. IZLOULEN - INTERNAL CONNECTIONS

The axis connecting the Noufla, N'Ouamass, and main Izloulou layers forms the spine of the settlement. This spine is integrated with narrow streets between buildings, access roads to the educational center, and narrow paths along the agricultural terraces. This organic network, articulated with the topography, is the fundamental element defining the texture of the settlement.

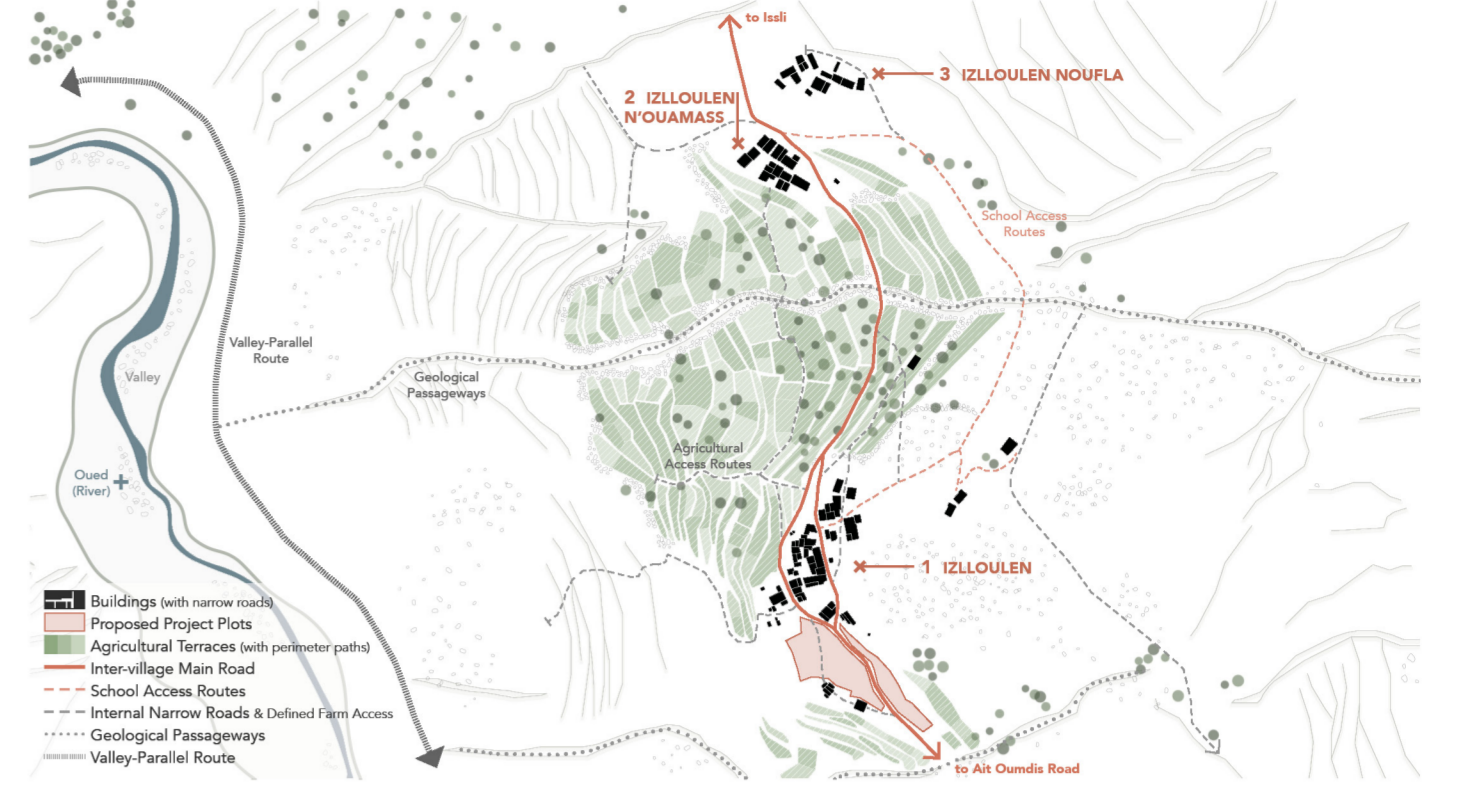

CLIMATE ANALYSIS

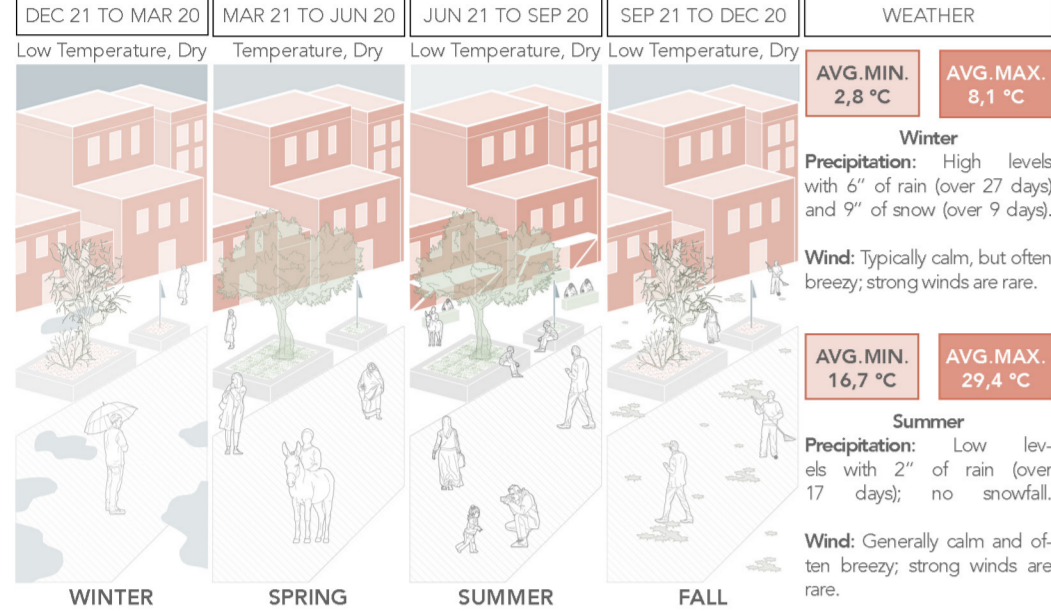

PROGRAM OF REQUIREMENTS

- Artisan Hub**
Women's Cooperative House (100 m²)
Workshop (40 m²)
Artisan Courtyard
- Religion Hub**
Izloulou Mosque (70 m²)
Mosque Square
- Social Life Center**
Souk (Marketplace) (open-air)
Health Center (45 m²)
Majlis (200 m²)
Majlis Square
- Educational Hub**
Classrooms (30 m² x 3)
Library (80 m²)
Staff Room (20 m²)
Restrooms
Educational Courtyard
- Resilience Hub**
Community Park & Assembly Point
- Tourism Hub**
Izloulou Information Point (20 m²)
Shops (25 m² x 3)
Accommodation Units (20 m² x 2)
Community Kitchen (50 m²)
- Housing**
Housing Units (min 5)
- Infrastructural & Technical**
Tool Storage (40 m²)
Agricultural Storage (40 m²)
Water Tank (40 m²)
Emergency Storage (40 m²)

Program and Design: The Izloulou settlement presents a layered profile shaped by seismic risks and structural deficiencies. The designed needs program aims to preserve Berber culture and increase post-disaster resilience at the local level.

Social and Cultural Continuity: The project aims to address the damage and loss of social life caused by the 2023 earthquake in the village. The designed 'Religion Hub' and 'Social Life Center' units are envisioned to serve as public focal points supporting the 'taïach' mutual aid system.

Economic Development and Tourism: The village's panoramic location and culture are considered a potential asset for sustainable development. The 'Artisan Hub' aims to preserve women's craft heritage, while the 'Tourism Hub' transforms this potential into a model provides income to the local community.

Education and Health Accessibility: Due to the difficulty in accessing the existing school, the goal is to relocate the education unit to a central location. The aim is to repurpose the vacated structure as an 'Emergency and Agricultural Storage Facility,' transforming it into a unit serving all three parts of Izloulou.

Technical Infrastructure and Resilience: The 'Infrastructural Hub' units are planned to support traditional irrigation systems, efficiently store agricultural crops and equipment, and enhance disaster response capacity.

Repair of Existing Fabric and Structural Strengthening: It is proposed that damaged structures be repaired and strengthened using local materials such as stone and earth, in accordance with their original form.

SITE SETTLEMENT DIAGRAMS

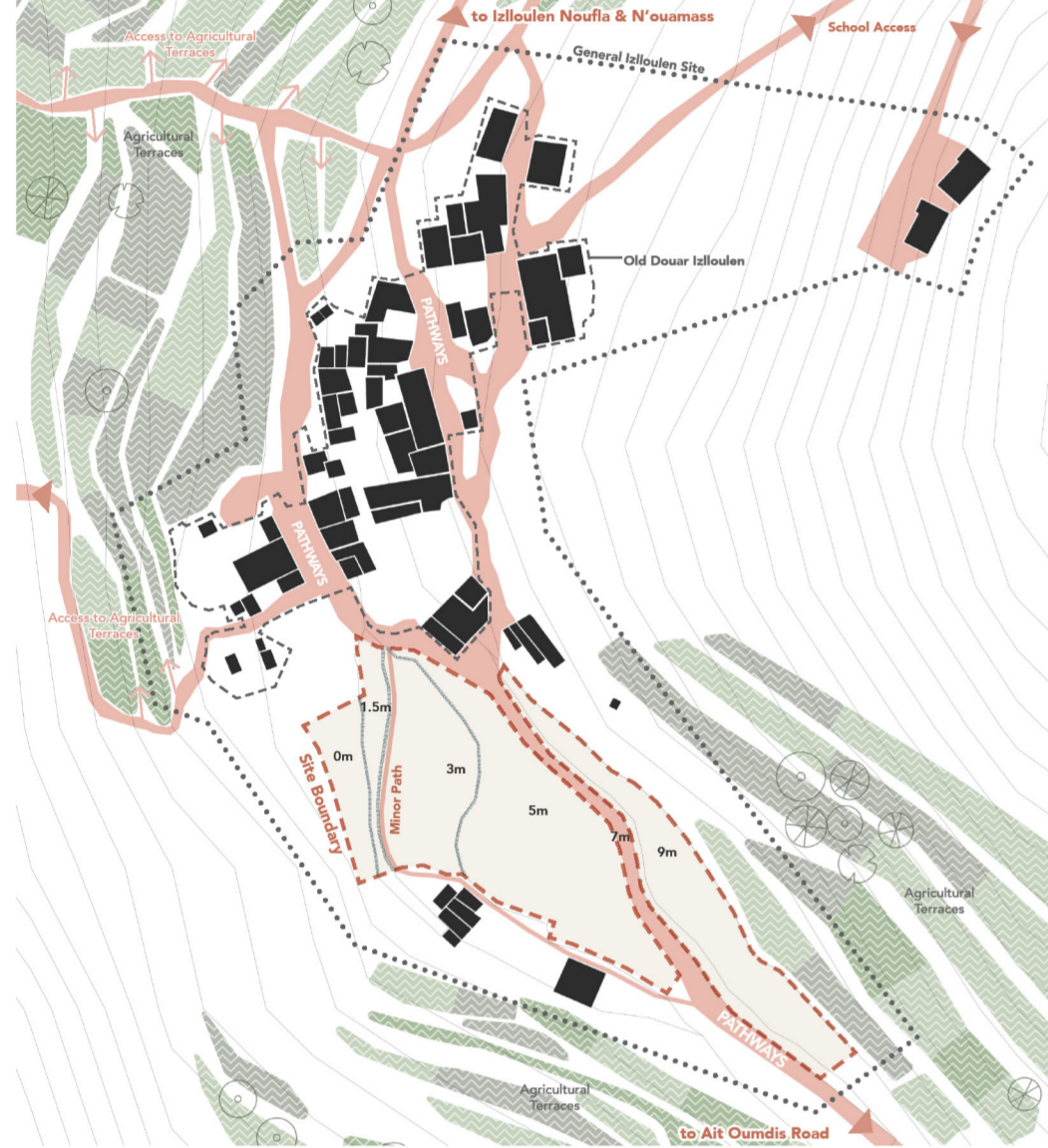

1. Existing Conditions

Currently, the douars internal transportation network consists of dirt roads. The main transportation axis connecting Noufla, N'Ouamass, and the main Izloulou layers divides the project area into two main zones and branches into two further sections. These two zones rise gradually in accordance with the topography, while a secondary minor path running through the area supports circulation.

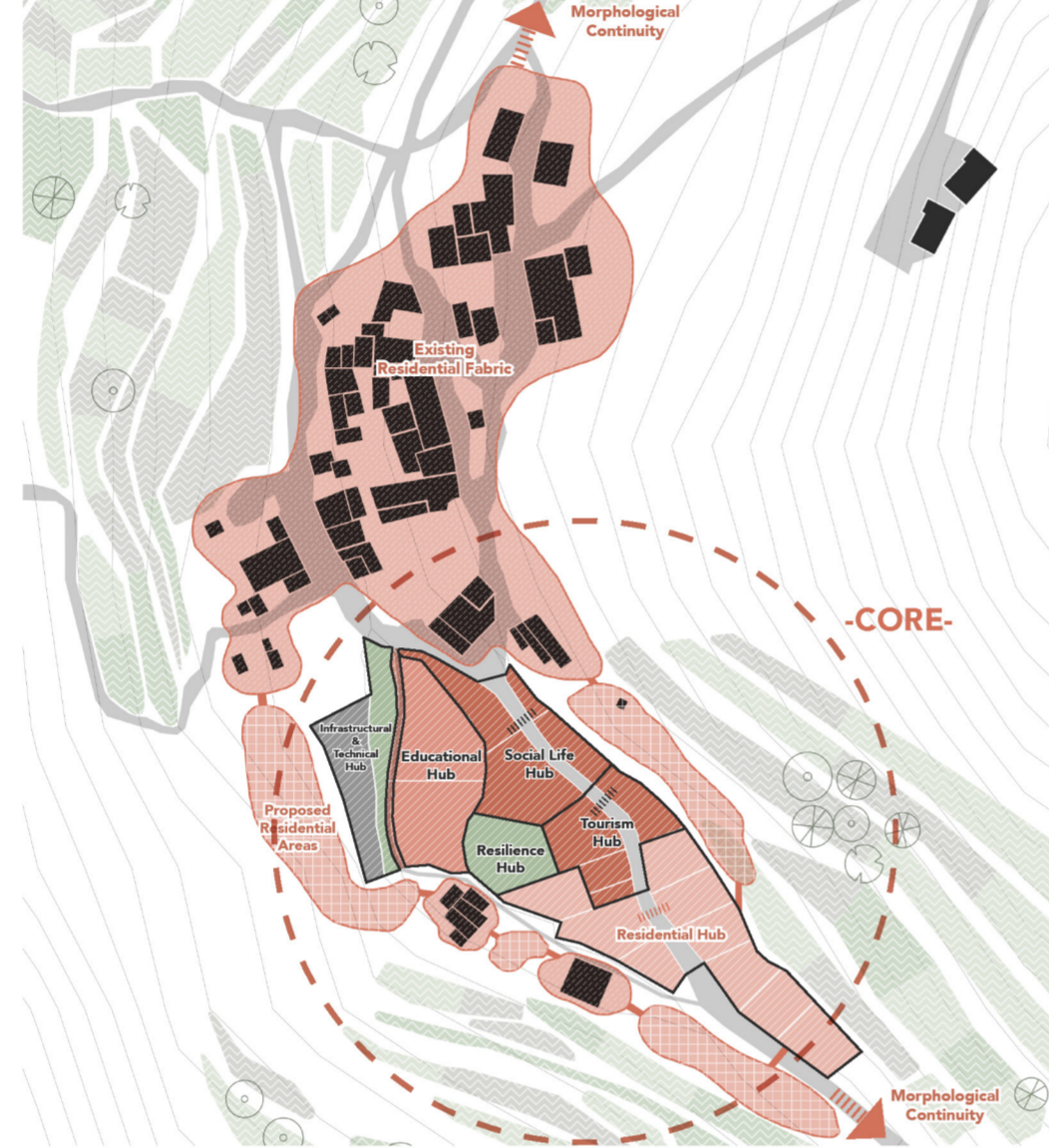

2. Morphological Continuity and Social Hubs

It is proposed that the existing residential fabric located in the north of the area be continued with morphological continuity along the axis that divides the region in two. As a result of this settlement strategy, the functions that constitute the 'CORE' units of the project and support local development are placed in the center of the area. Through to the 'CONNECT' network designed between these focal points, the aim is to transform the fragmented structure into a holistic social network and to revitalize the settlement with the CORE-NECT vision.

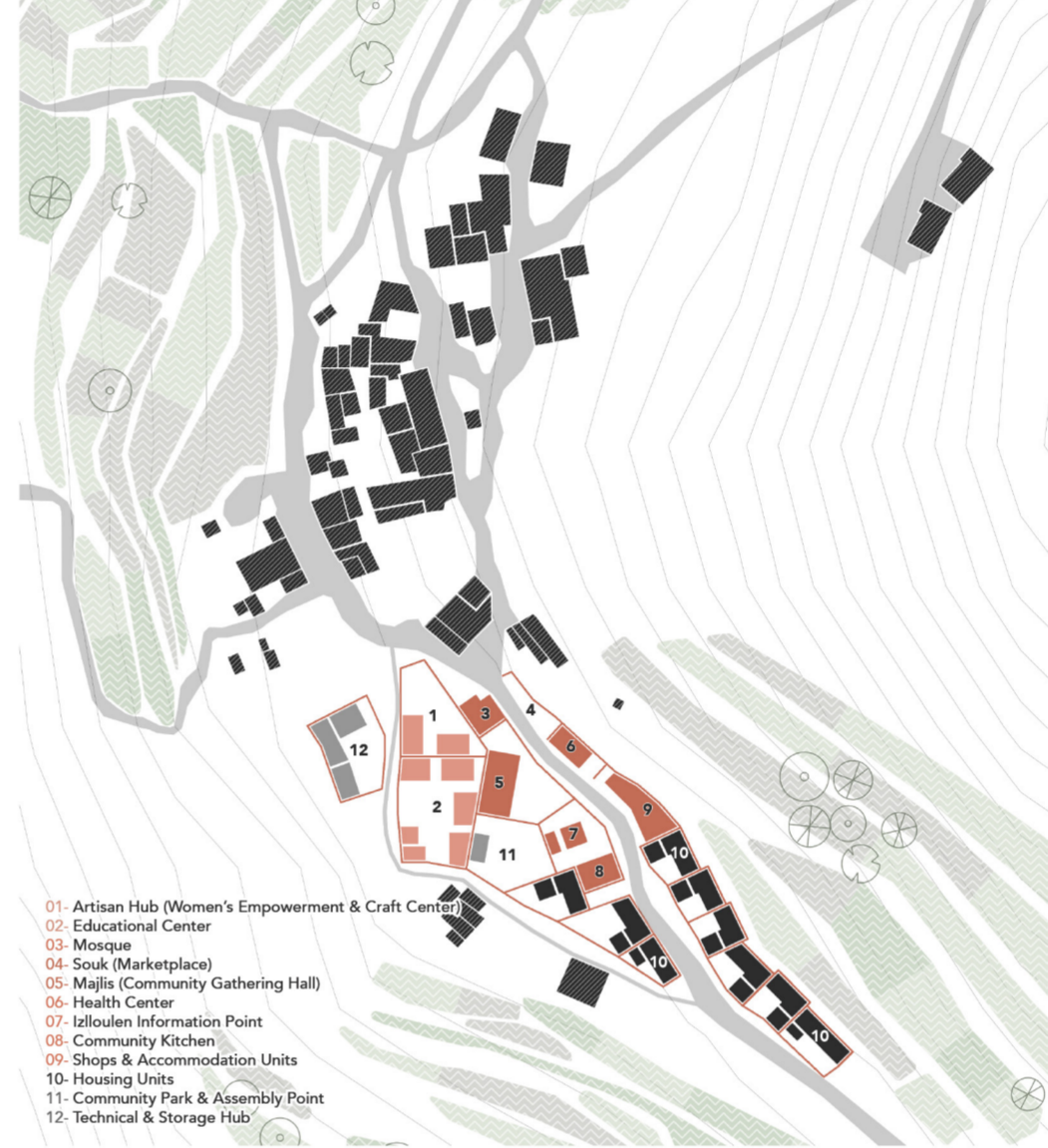

3. Parceling and Mass Arrangement

The focal points of the project area were divided into functional units in accordance with the defined requirement program, and a parceling scheme was designed accordingly. In this process, each building mass was positioned based on the square meter requirements in the program, the orientation towards the view, and its relationship with the traditional texture of the douar.

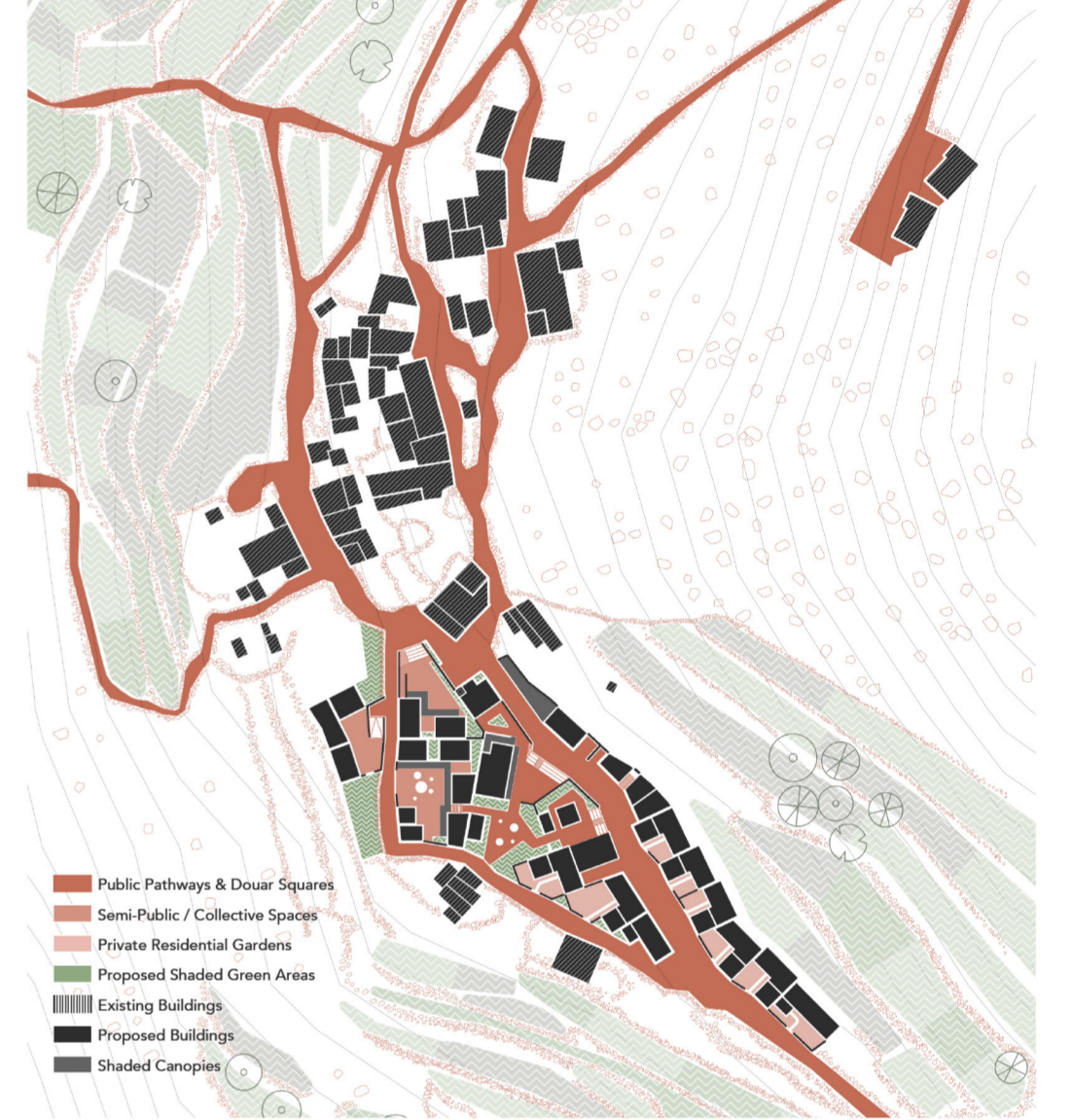

4. Social Spine and Public Centers

The main axis of the design enhances social interaction with public focal points such as the Mosque, Majlis, and Tourist Square. Access to the educational and storage units is integrated with the main circulation scheme, but is provided via a semi-public threshold defined by garden walls and entrance gates. Shaded microclimate areas are created in these focal points with local vegetation, and physical continuity and spatial integrity between the buildings are ensured by the eaves systems at ground level.

SITE PLAN SCALE: 1/1000

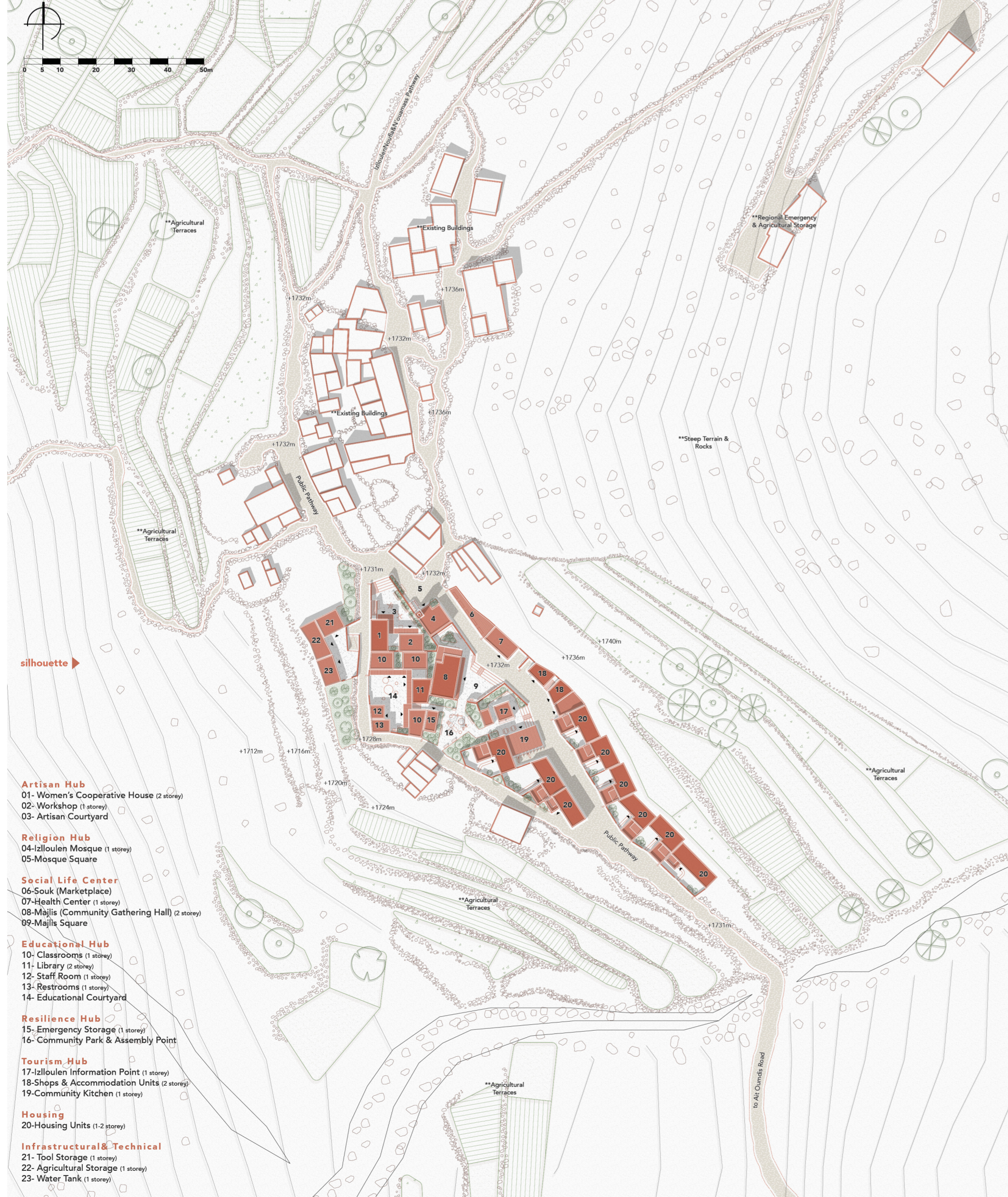

AXONOMETRIC DIAGRAM of IZLOULEN

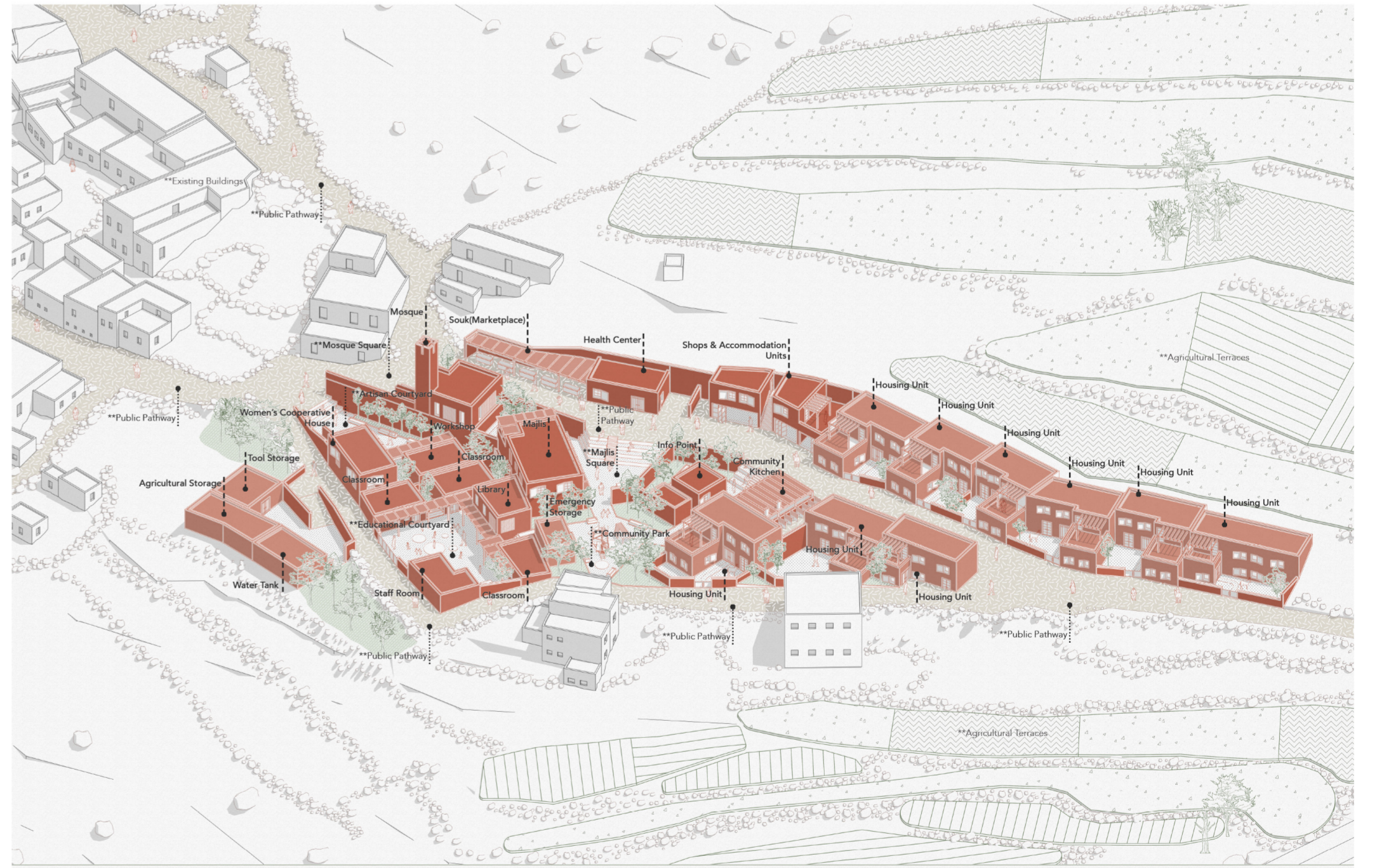

- Artisan Hub**
01-Women's Cooperative House (2 story)
02-Workshop (1 story)
03-Artisan Courtyard
- Religion Hub**
04-Izloulou Mosque (1 story)
05-Mosque Square
- Social Life Center**
06-Souk (Marketplace)
07-Health Center (1 story)
08-Majlis (Community Gathering Hall) (2 story)
09-Majlis Square
- Educational Hub**
10-Classrooms (1 story)
11-Library (2 story)
12-Staff Room (1 story)
13-Restrooms (1 story)
14-Educational Courtyard
- Resilience Hub**
15-Emergency Storage (1 story)
16-Community Park & Assembly Point
- Tourism Hub**
17-Izloulou Information Point (1 story)
18-Shops & Accommodation Units (2 story)
19-Community Kitchen (1 story)
- Housing**
20-Housing Units (1 story)
- Infrastructural & Technical**
21-Tool Storage (1 story)
22-Agricultural Storage (1 story)
23-Water Tank (1 story)

DOUAR IZLOULEN WEST SILHOUETTE SCALE: 1/1000

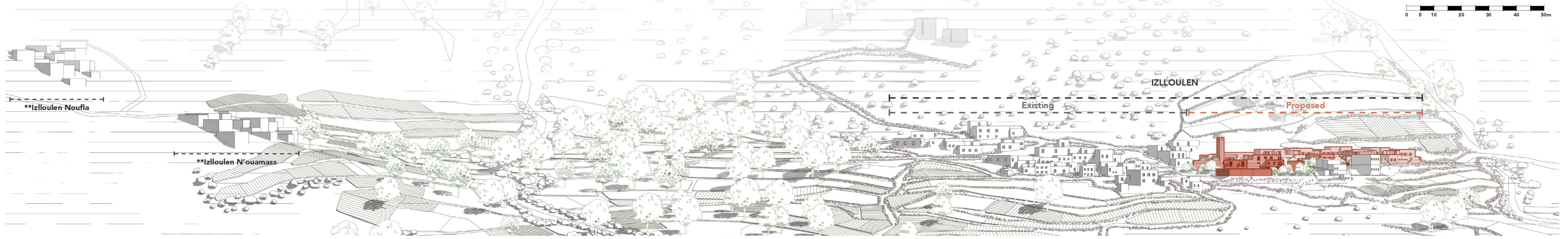

GROUND LEVEL PLAN SCALE: 1/500



SECOND FLOOR PLANS

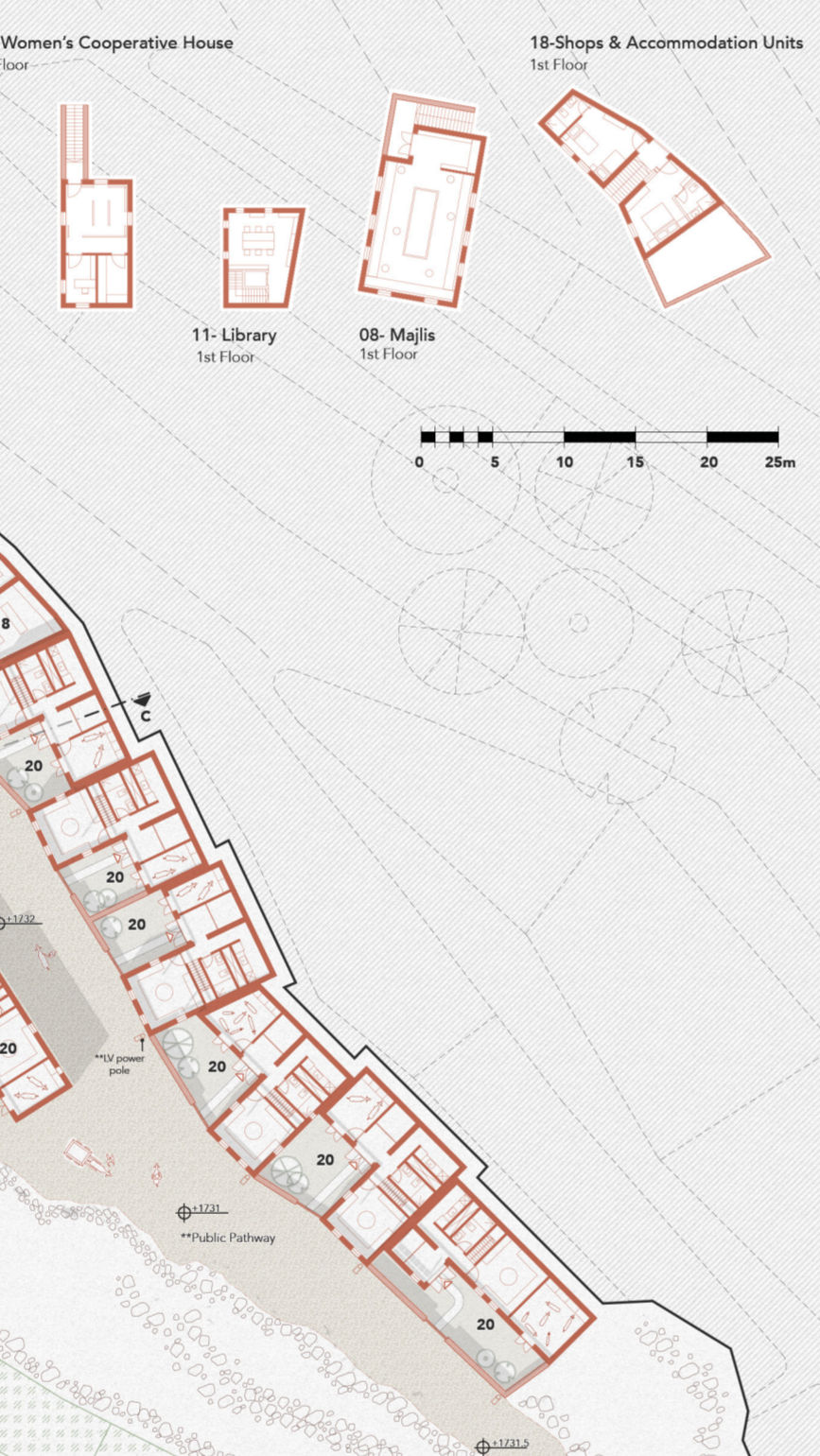

MODULER LIVING UNITS

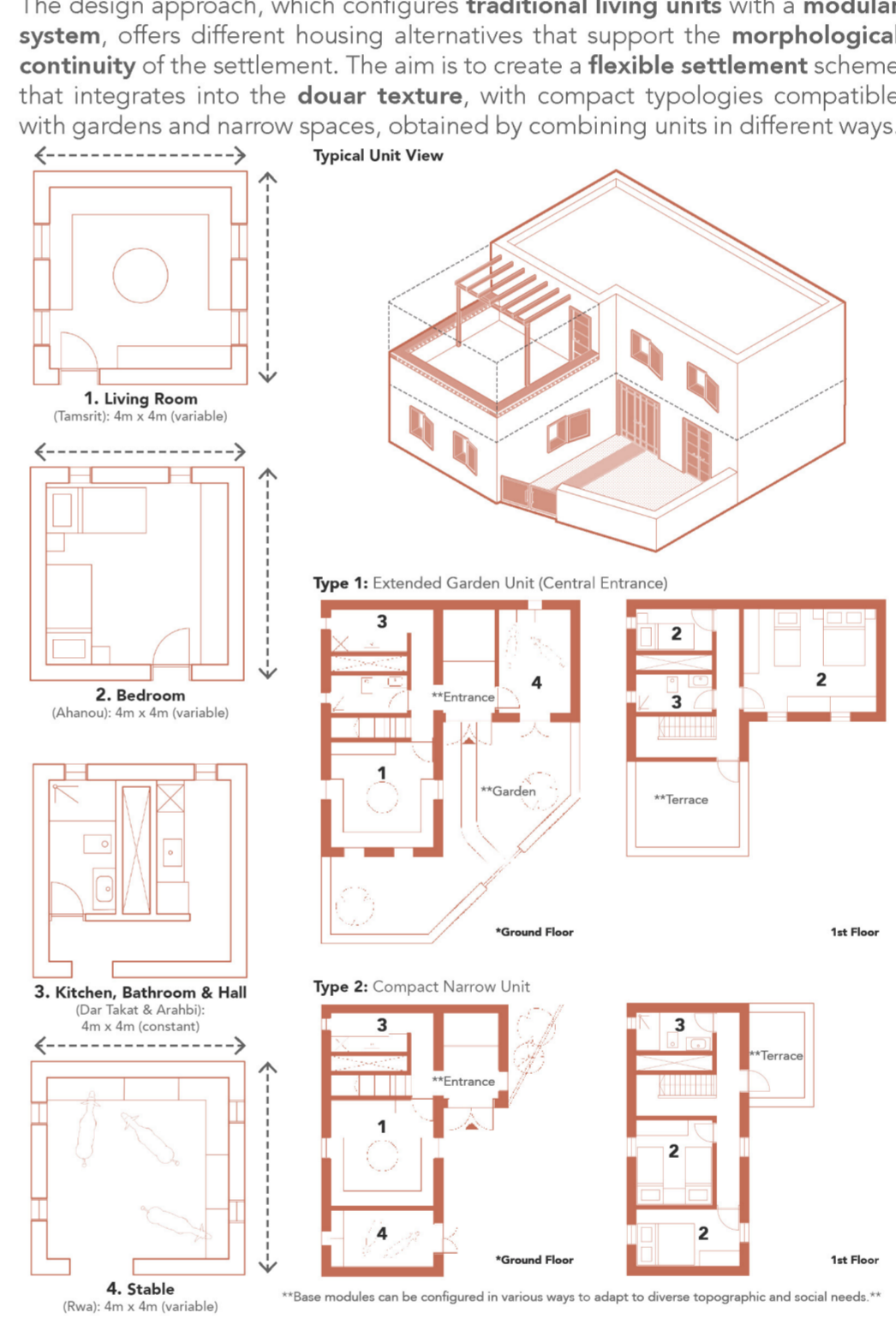

SQUARES- UNIT DIAGRAMS

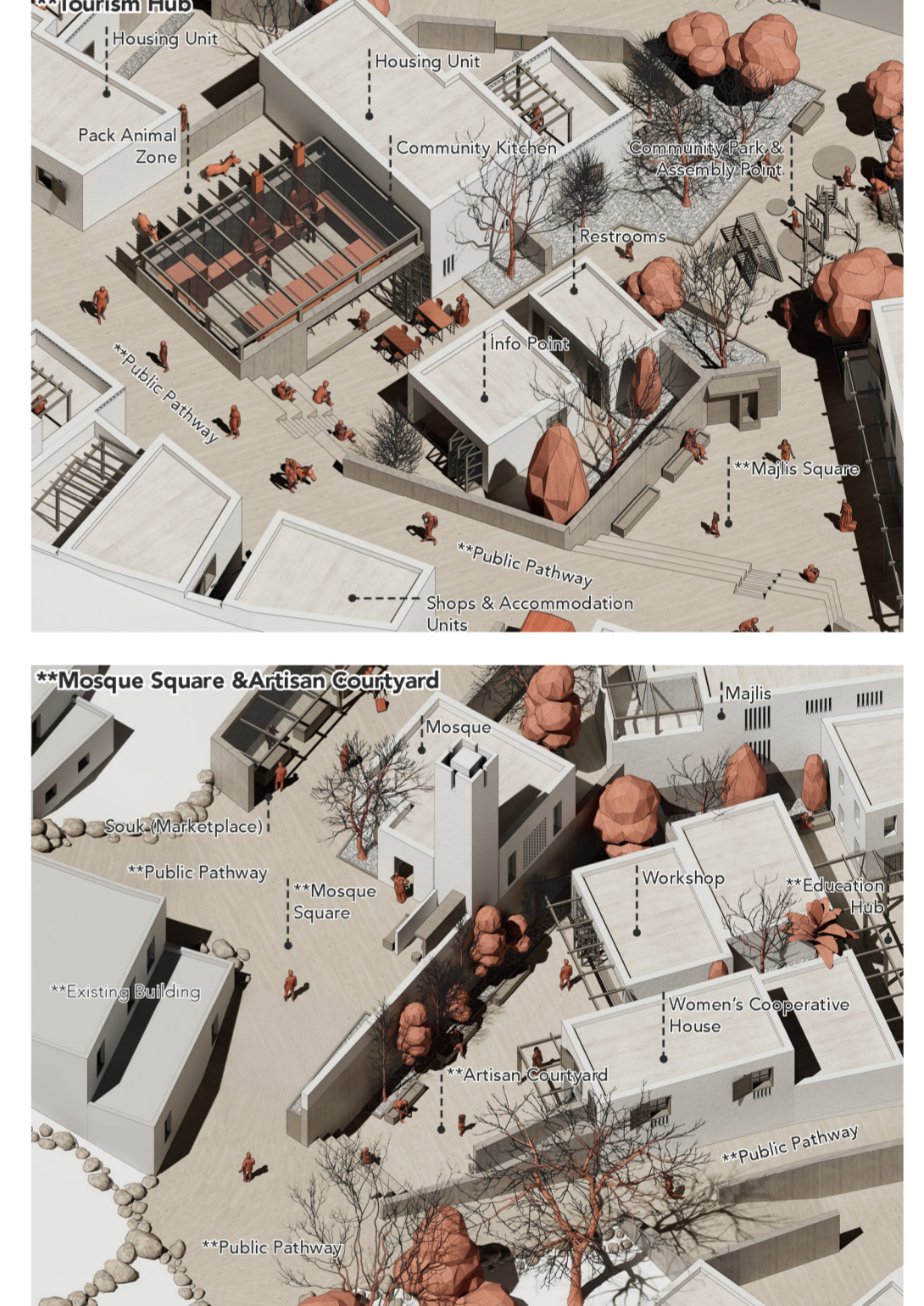

SECTIONS SCALE: 1/500

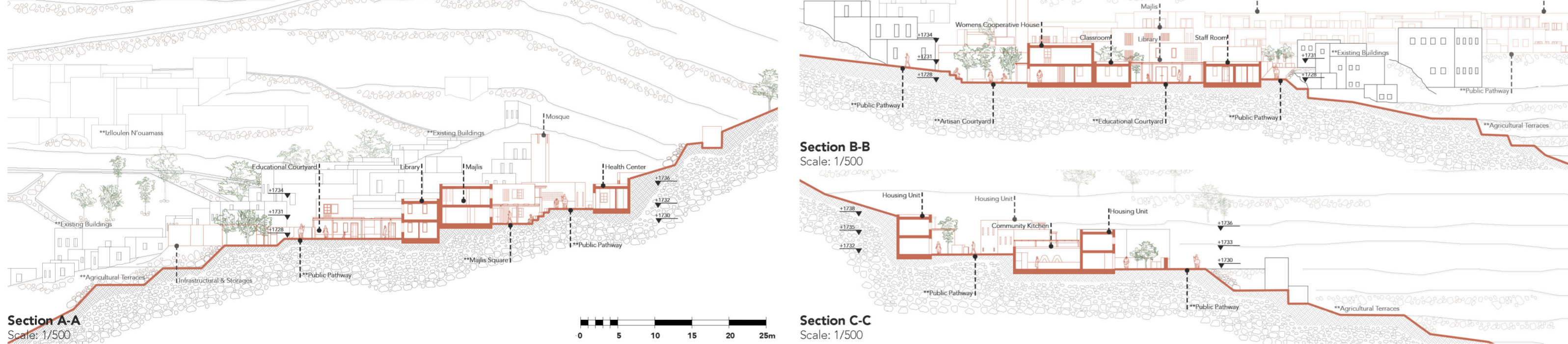

THE SEGUIA NETWORK



The Seguia water line, fed by the mountain, reaches the social units and agricultural terraces along the slope. The structures store the rainwater collected from their terraces in their own cisterns for garden use. Water exceeding the cistern capacity is transferred to the Seguia network via drainage lines and stored.

RESILIENT ENERGY INFRASTRUCTURE

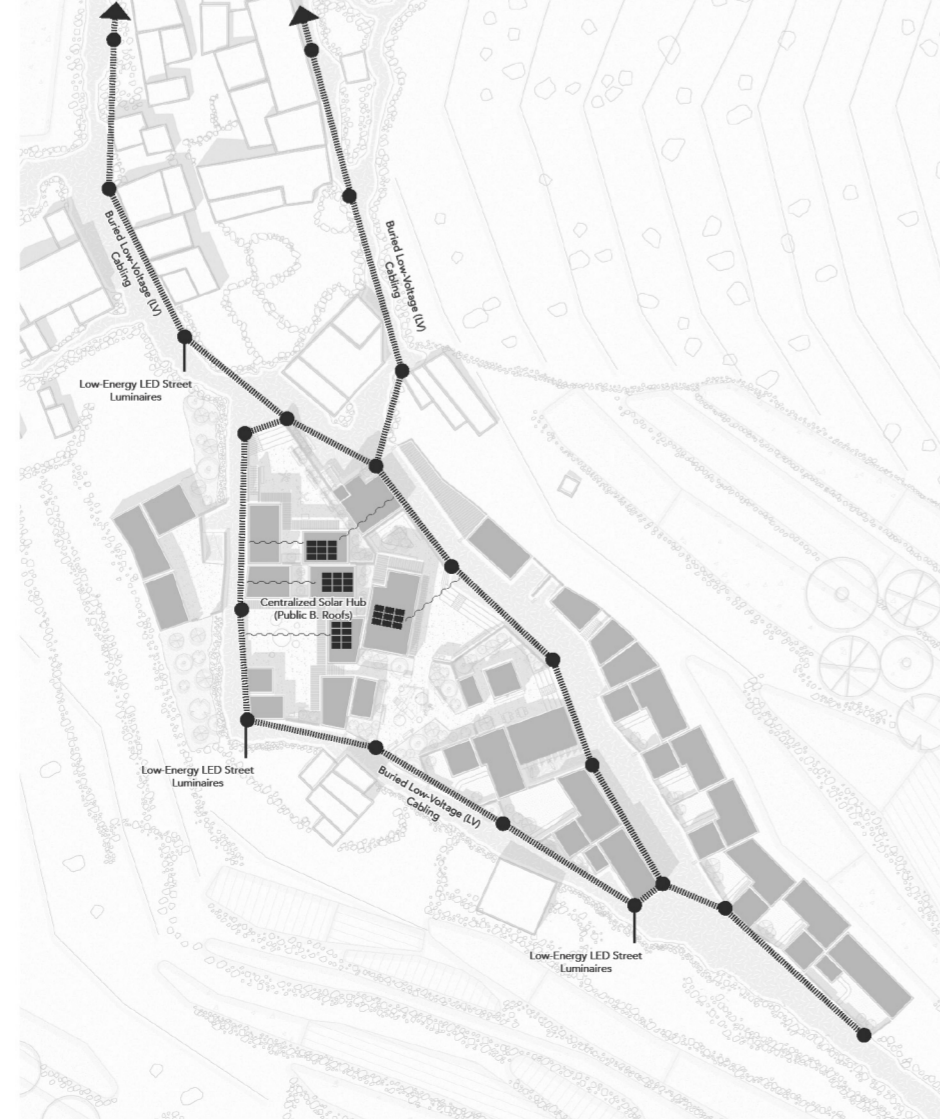

The settlement's energy infrastructure is designed through an integrated service corridor with Seguia to minimize installation and maintenance costs. Energy production is provided by solar panels installed on public buildings due to high costs, and then distributed to the douar via the grid. This network is a low-cost solution that ensures energy continuity in the post-disaster period.

STRUCTURAL TECTONICS: LOCAL SEISMIC UPGRADES

